

accessible

smooth

versatile

*it all
starts
with a
vision*

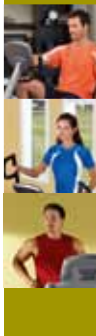

1600 Landmark Drive • Cottage Grove, WI 53527
toll free 800.335.4348 • fax 608.839.8731
www.visionfitness.com

©2009 Vision Fitness. All Rights Reserved. May be covered by one or more patents or patents pending. US 5540637, US 5573480,
US 5813949, US 5812949, US 5924962, US 5938567, US 6135927, US 6149551, US 7316633, TW 364373, TW 371899, CN 99880486.7
9.09
AG18.28RD
REV5



ASSEMBLY GUIDE



X6200
FOLDING ELLIPTICAL TRAINER

TOOLS & PARTS INCLUDED

Screwdriver

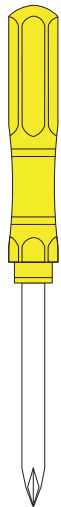

5mm T-Shaped Wrench

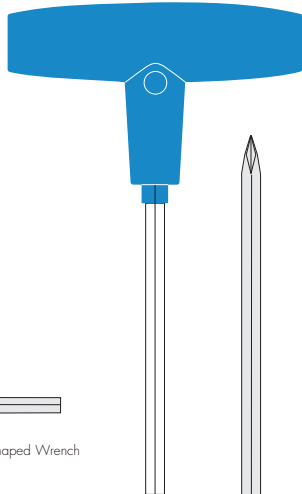

13mm/15mm Wrench

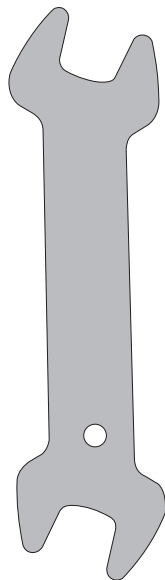

4mm L-Shaped Wrench

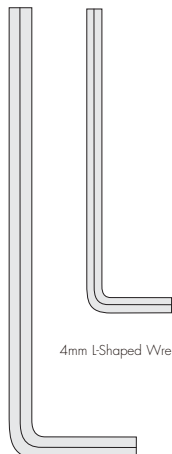

5mm L-Shaped Wrench

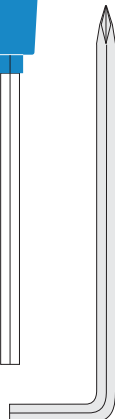

6mm L-Shaped Wrench

PARTS BOX

- Dual-Action Axle Covers
- Pedal Arm Bracket Covers
- Pedal Support Bracket
- Water Bottle & Cage
- Power Supply
- Color-coded Hardware Bags
- Assembly Guide
- Warranty Card

GREEN BAG

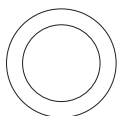

20x29x1.5T Wavy Washer
Quantity: 2



M8x13L Screw
Quantity: 6



BLACK BAG



54x8x2T Sleeve Cover
Quantity: 2



M8 Nut
Quantity: 2



4x15L Pan-Head Bolt
Quantity: 2



8x25x1.5T Washer
Quantity: 2



M8x30L Bolt
Quantity: 2



M5x12L Bolt
Quantity: 4



5x10x1T Washer
Quantity: 4

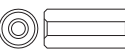

Link Arm Sleeve
Quantity: 2



8.2x15.4x2T Washer
Quantity: 6

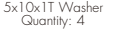

8x18x1T Washer
Quantity: 2



26.4x33.9x0.3T Wavy Washer
Quantity: 2



M8x13L Bolt
Quantity: 6



8.3x28.5x2T Washer
Quantity: 2



25.3x32x1.0T Washer
Quantity: 2



6x12x1.0T Washer
Quantity: 4



M6x15L Bolt
Quantity: 4

ORANGE BAG



8x14x1T Washer
Quantity: 2



17x40x1.0T Washer
Quantity: 2



M8x20L Bolt
Quantity: 2



8.2x15.4x2T Washer
Quantity: 6



8.5x20x1T Washer
Quantity: 4



M8x20L Bolt
Quantity: 6



8.4x17x1.0T Arc Washer
Quantity: 2

BLUE BAG



5x10x1T Washer
Quantity: 2



25x34x2T Wavy Washer
Quantity: 2



M5x10L Bolt
Quantity: 2

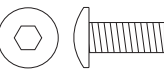

M8x20L Bolt
Quantity: 2

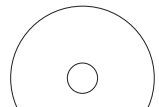

8x38x2.0T Washer
Quantity: 2

YELLOW BAG



M8x25L Bolt
Quantity: 4



8x17x1T Arc Washer
Quantity: 4

Assembly Guide

X6200 FOLDING ELLIPTICAL TRAINER

To avoid possible damage to this Elliptical Trainer, please follow these assembly steps in the correct order. Before proceeding, find your new Elliptical Trainer's serial number located on the front axle tube, and enter here:

Refer to this number when calling for service, and enter this serial number on your Warranty Card and in your own records. Be sure to read your Owner's Guide before using your new Elliptical Trainer. If any parts, hardware or tools are missing, please call 1.800.335.4348

NOTE: It is recommended that you apply grease to the threads of each screw as you assemble your Elliptical Trainer to prevent loosening and noise. Also, during each assembly step, ensure that ALL screws are in place and partially threaded in before completely tightening any ONE screw.

STEP 1 YELLOW BAG

- Place a piece of packaging under the front of the unit to aid in assembly.
- Secure the front stabilizer to the base frame plate with four bolts (M8x25L) and four arc washers (8x17x1.0T). Tighten with the 5mm L-shaped wrench.

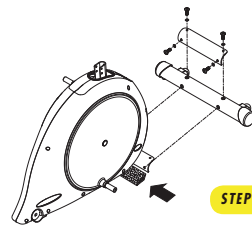

STEP 2 ORANGE BAG

- Place a piece of packaging under the front of the unit to aid in assembly.
- Slide the axle through the plastic sleeve of the frame. Slide a washer (17x40x1.0T) onto each side of the axle. Slide the left guide rail onto the left side of the axle and the right guide rail onto the right side of the axle.
- Slide the right stabilizer onto the right side of the axle and the left stabilizer onto the left side of the axle. Fix each side in place with a washer (8x14x1T) and bolt (M8x20L). Tighten with a 5mm T-shaped wrench.

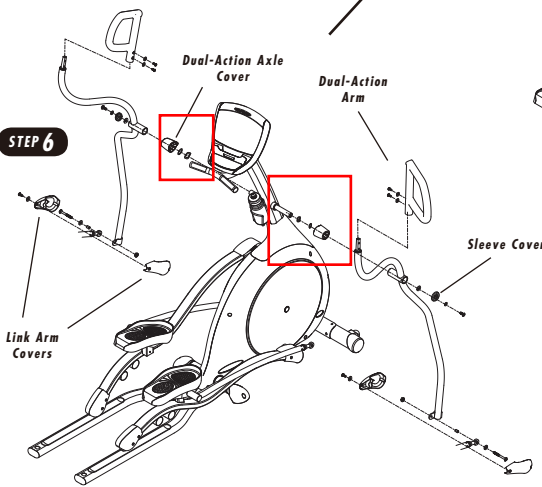

STEP 3 BLUE BAG

- Slide a wavy washer (25x34x2T) onto the right rotation axle. Slide the bushing housing of the right pedal arm onto the right rotation axle. The pedal arm roller wheel should be placed in the groove of the guide rail. Secure the pedal arm to the rotation axle with a washer (8x38x2.0T) and bolt (M8x20L). Tighten with a 5mm T-shaped wrench.
- Place the pedal arm bracket cover over the bushing housing of the pedal arm. Secure in place with a washer (5x10x1T) and bolt (M5x10L). Tighten with the screwdriver.
- Repeat both steps on the left side.

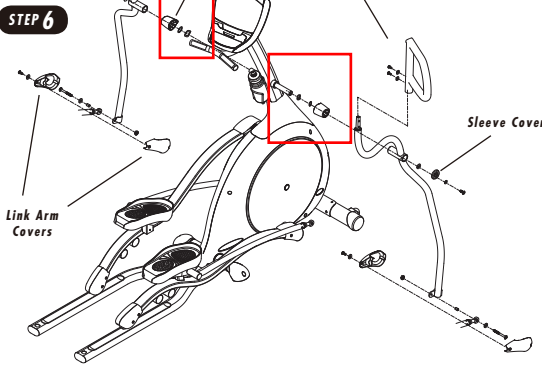

STEP 2

STEP 3

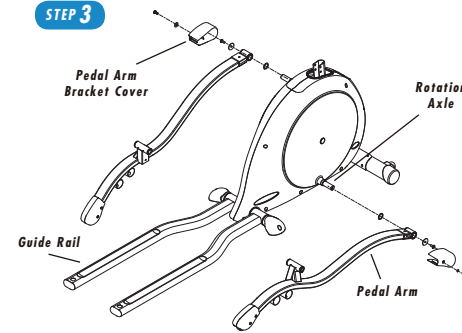
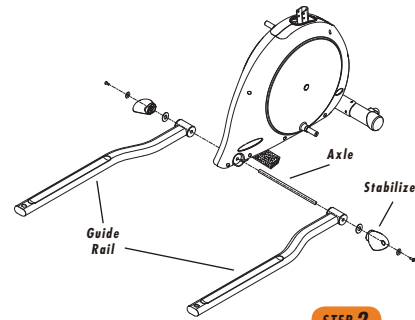

STEP 4

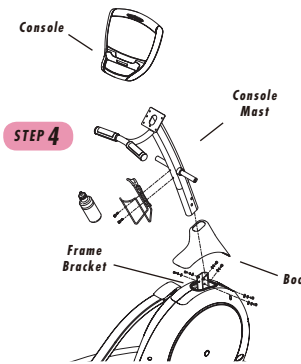

STEP 5

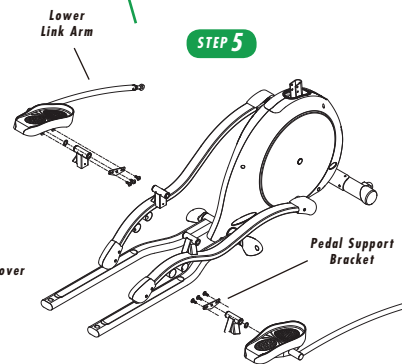

STEP 4 PINK BAG

- Slide the boot onto the console mast.
- Unfold the wire harness located in the frame bracket. Wrap the wire tie around the end of the wire harness. Pull the wire tie and wire harness up through the top of the console mast while simultaneously sliding the mast into the frame bracket.
- Secure the console mast to the frame bracket using six bolts (M8x20L), six lock washers (8.2x15.4x2T), four flat washers (8.5x20x1T), and two arc washers (8.4x17x1.0T). **NOTE:** Use the two arc washers on the front of the console mast. Tighten with the 6mm L-shaped wrench.
- Slide the boot down the console mast and snap it in place on top of the side cover.
- Remove the four screws from the back of the console. Connect the wire harness to the plug in the back of the console. Connect the heart rate wires from the console mast to the console. Attach the console to the console mast with the four screws.
- Attach the water bottle cage with the screwdriver and the screws located in the console mast.

STEP 5 GREEN BAG

- Slide a wavy washer (20x29x1.5T) on the lower link arm axle, which is located under the foot plate. Slide the axle through the bracket located on top of the pedal arm.
- Secure the lower link arm to the pedal arm by attaching the pedal support bracket with three bolts (M8x13L). Tighten with the 5mm T-shaped wrench.
- Repeat this step on opposite side.

STEP 6 BLACK BAG

- On the right side, slide one washer (26.4x33.9x0.3T), another washer (25.3x32.0x1.0T) and dual action axle cover into place on the console mast axle. Slide the right dual action arm on the axle. Fix in place with the washer (8x28.5x2T), sleeve cover, washer (8x18x1T) and bolt (M8x13L).

STEP 7 CONSOLE

- Refer to **Product Selection and Model Configuration** decal on console or follow these steps.
- Once the product is plugged in turn on the console.
- Select product (Bike [BK] or Elliptical [EP]) using the resistance arrow keys. Press ENTER to select.
- Select model number (Bike [1,500, 2050, 2250, 3200] or Elliptical [1,500, 6000, 6200]) using the RESISTANCE arrow keys. Press ENTER to select. Console will reset to start-up screen.
- The product selection and model configuration is now complete.

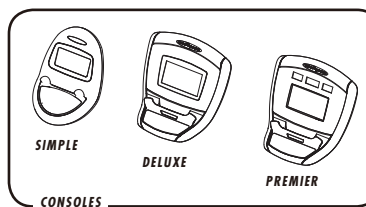

- Make sure the link arm sleeve is in place in the socket joint of the lower link arm. Connect the lower link arm to the dual action arm with a bolt (M8x30L). Attach the washer (8x25x1.5T) and nut (M8) to the end of the bolt. Tighten with the 5mm L-shaped wrench and 13mm wrench.
- Position the link arm cover over the joint of the lower link arm and secure the two pieces of the cover together with a panhead bolt (M4x15L). Connect the cover to each side of the lower link arm with a washer (5x10x1T) and bolt (M5x12L).
- Set multi-position grip on the dual action arm. Secure with two washers (6x12x1.0T) and two bolts (M6x15L). Tighten with the 4mm L-shaped wrench.
- Repeat these steps on the left side.